







- No Upper Chain
- First Floor Apartment
- Ideal First Time Buy
- Private Courtyard
- Two Bedrooms
- Great Location
- Good Transport Links
- Viewing Recommended





Offered for sale with no upper chain this two bedroom apartment located within the popular Staithes development must be viewed.

The property will appeal to a variety of buyers and briefly comprises:- entrance hallway, stairs leading to the first floor, open plan dual aspect lounge kitchen/diner with fitted units, two bedrooms and a three piece bathroom with overhead shower. The property benefits from electric heating and double glazing. Externally there is a private courtyard located to the rear of the property.

Early viewings are recommended. Please call our sales team on 0191 487 0800 for more information or to book a viewing.

#### Covid-19 Viewing Guidelines

For the safety of our clients, yourselves and our staff we are currently only allowing viewings to go ahead if viewers wear appropriate PPE (masks and gloves). Social distancing rules must also be adhered to at all times. Where possible we will encourage vendors to leave the property while the viewing is going ahead. We also will only allow 2 people to view a property at any one time. We may share contact numbers where requested by NHS to prevent the spread of Covid-19.





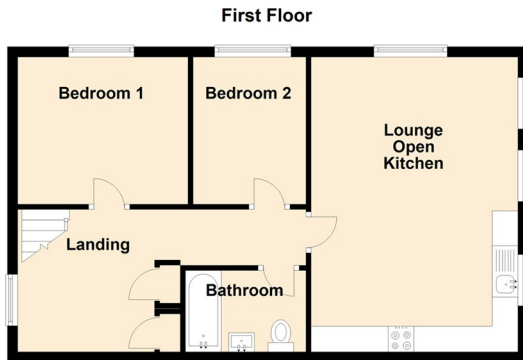

Lounge/Kitchen/Diner 18'9" x 12'8" (5.73 x 3.87)

Bedroom One 10'7" x 9'4" (3.23 x 2.87)

Bedroom Two 9'4" x 7'3" (2.86 x 2.22)

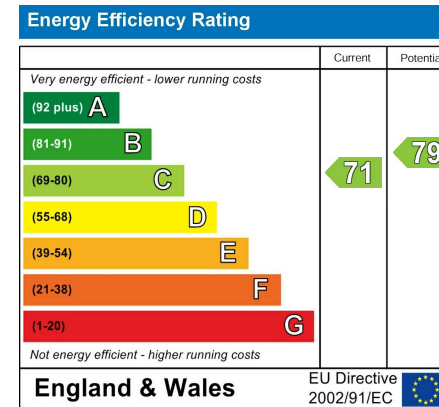

## The difference between house and home

You may download, store and use the material for your own personal use and research. You may not republish, retransmit, redistribute or otherwise make the material available to any party or make the same available on any website, online service or bulletin board of your own or of any other party or make the same available in hard copy or in any other media without the website owner's express prior written consent. The website owner's copyright must remain on all reproductions of material taken from this website.

Gosforth 0191 236 2070  
 Newcastle 0191 284 4050  
 Forest Hall 0191 605 3134  
 High Heaton 0191 270 1122  
 Low Fell 0191 487 0800  
 Tynemouth 0191 257 2000  
 Whitley Bay 0191 251 3000  
 Property Management Centre 0191 236 2680



[www.janforsterestates.com](http://www.janforsterestates.com)

